

# Accutorr® 3

## Specifications

### Interfacing

Connectors: Serial port for software upgrade and DIAP protocol

### Battery

Type: Rechargeable lithium ion  
 Run Time: Up to 22 hours when powered by a new fully-charged battery at 77°F±41°F (25°C±5°C) with SpO<sub>2</sub> and NIBP measurements at an interval of 15 minutes.

### Charge Time

Monitor Power Off: Less than 5.5 hours to 90%;  
 Less than 6.5 hours to 100%  
 Monitor Power On: Less than 10.5 hours to 90%;  
 Less than 11.5 hours to 100%

### Physical Dimensions

Dimension: 9.6" (H) x 4.7" (W) x 5.3" (D)  
 24.4 cm (H) x 11.9 cm (W) x 13.5 cm (D)  
 Weight: <4.2 lbs (<1.9 kg) including battery

### Environmental Conditions

Operating Temperature: 0°C to 40°C (SmarTemp™: 5°C to 40°C)  
 Operating Humidity: 15% to 95%, non-condensing  
 Barometric: 427.5 to 805.5 mmHg (57.0 to 107.4 kPa)

### Power Requirements

100 to 240 VAC, 0.9 to 0.5 A, 50/60 Hz

### Safety

Type of Protection: Meets the requirements of IEC 60601 series



Top

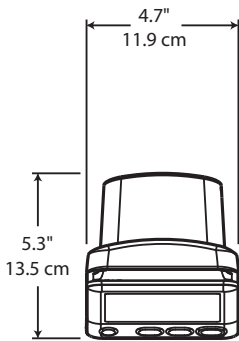

Front

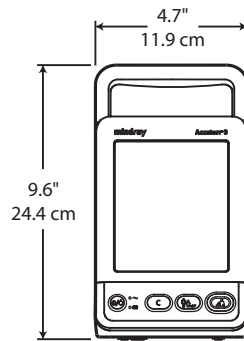

Side

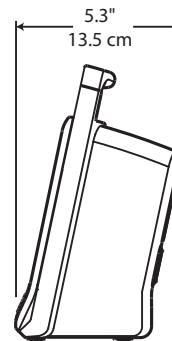

Top with Temperature

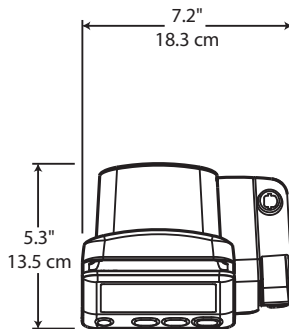

Front with Temperature

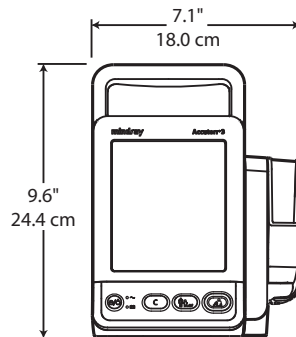

Side with Temperature

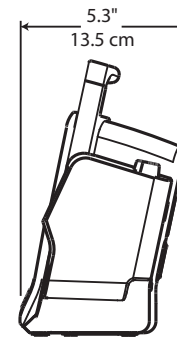

# Accutorr® 3

## Specifications

---

### Mounting Solutions

#### Pivot Arm Wall Mount

Moment Load: 60 lbs (27.2 kg)

Lateral Range of Motion

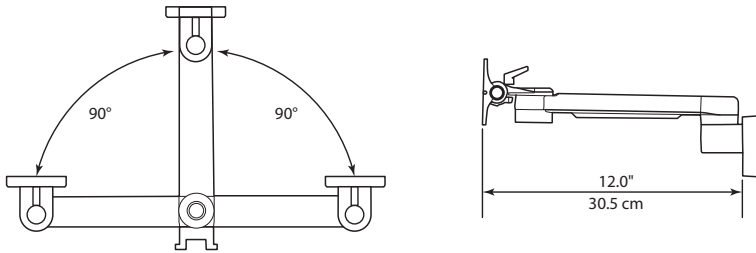

### Rolling Stand

Dimension: 47" (H) x 27" (W) x 27" (D)  
119.4 cm (H) x 68.6 cm (W) x 68.6 cm (D)

Moment Load: 35 lbs (15.9 kg)

Max Head Tilt: 10 degrees

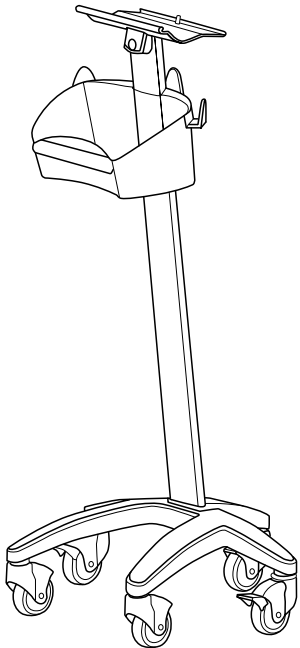

Mindray DS USA, Inc.

800 MacArthur Blvd., Mahwah, NJ 07430

Tel: 800.288.2121 Tel: 201.995.8000 Fax: 800.926.4275 [www.mindray.com](http://www.mindray.com)

©2014 Mindray DS USA, Inc.

Mindray® is a registered trademark of Shenzhen Mindray Bio-Medical Electronics Co., Ltd.

01/15 P/N: 0002-08-6381 Rev B

**mindray**  
NORTH AMERICA